



# LATE MODEL ECO LIFT ASSEMBLY MANUAL

# WARRANTY DISCLAIMER

## READ BEFORE USING PRODUCT

This product is a specialized lift designed exclusively for lightweight competition vehicles, specifically those weighing less than 4500 pounds and used off-highway. It is important to note that DirtCarLift.com does not have direct knowledge of the individuals who will utilize this lift or the specific contexts in which it will be employed.

This lift is a component that should be integrated into a larger system. It is crucial to use additional safety equipment, such as jack stands, which are not supplied with this product. Furthermore, only individuals who are proficient in operating hydraulic lifts should handle this equipment.

Due to the variable nature of how this lift may be used, DirtCarLift.com cannot provide any warranty, whether explicit or implied. The responsibility to determine the appropriateness of this lift for a particular racing application rests solely with the end user. It is imperative to understand that this lift is not designed for, nor should it be used in, vehicles that are driven on public highways. It has not been certified for such use. Improper use of this product could lead to severe injury or even fatality. The end user assumes all responsibility for any risks associated with the use of this lift

**PLEASE CYCLE LIFT UP AND DOWN AT LEAST TWICE TO BLEED AIR FROM THE HYDRAULIC SYSTEM BEFORE LIFTING YOUR CAR. FAILURE TO DO SO MAY RESULT IN THE LIFT TWISTING.**

**BEWARE OF:**

- PINCH POINTS
- OVER TIGHTENING FASTENERS
- STRIPPING FASTNERS
- INSUFFICIENT GREASING
- LOOSE PARTS
- LOSING PARTS

**DO NOT:**

- EXCEED WEIGHT LIMIT OF 4500 POUNDS
- CUT INTO OR SHAVE OFF ANY MATERIAL FROM THE PRODUCT
- REPLACE OR CHANGE PARTS, UNLESS OTHERWISE INSTRUCTED BY MANUFACTURER
- OPERATE A DAMAGED PRODUCT
- INSTALL OR USE PRODUCT UPSIDE DOWN
- EXCESSIVELY DRIVE BOLTS AFTER THEY HAVE BEEN FULLY SEATED
- ASSEMBLE ANY PARTS WITHOUT READING THE NOTES
- ASSEMBLE TIGHT FIT PARTS WITHOUT PROPERLY GREASING THEM
- USE INCOMPATIBLE GREASE OR HYDRAULIC FLUID WITH THE LIFT

ITEM NO.	PART NUMBER	QTY.
1	1/4-20X.5" FLATHEAD SCREW	12
2	3/8-16 LOCKNUT	4
3	3/8-16X6.5" HEX HEAD SCREW	2
4	3/8-16X8" HEX HEAD SCREW	2
5	5/16-18 NUT	3
6	5/16-18X2" SOCKET HEAD CAP SCREW	3
7	BLACK SPACER	36
8	BOLT SUPPORT HEX	1
9	BOLT SUPPORT RUNNER	1
11	ECO HANDLE LONG BAR	2
12	ECO LADDER	4
13	ECO LONG BAR	2
14	ECO REAR LADDER	4
15	ECO THREADED LONG BAR	4
16	ENDCAP	12
17	HEX 4.25 W/HOLES	1
18	HEX 5.5	1
19	HEX 5.875	1
20	HEX 7.125	1
21	HYDRAULIC CYLINDER	2
22	HYDRAULIC SPACER LONG	1
23	HYDRAULIC SPACER LONG W/GROOVE	1
24	HYDRAULIC SPACER SHORT	1
25	HYDRAULIC SPACER SHORT W/GROOVE	1
26	LATE MODEL ECO FRONT XBAR	1
27	LATE MODEL ECO REAR XBAR	1
28	RISER RF	1
29	RUNNER 4.25	3
30	RUNNER 5.875	3
31	STEEL SUPPORT 6.75	1
32	STEEL SUPPORT 8.375	1

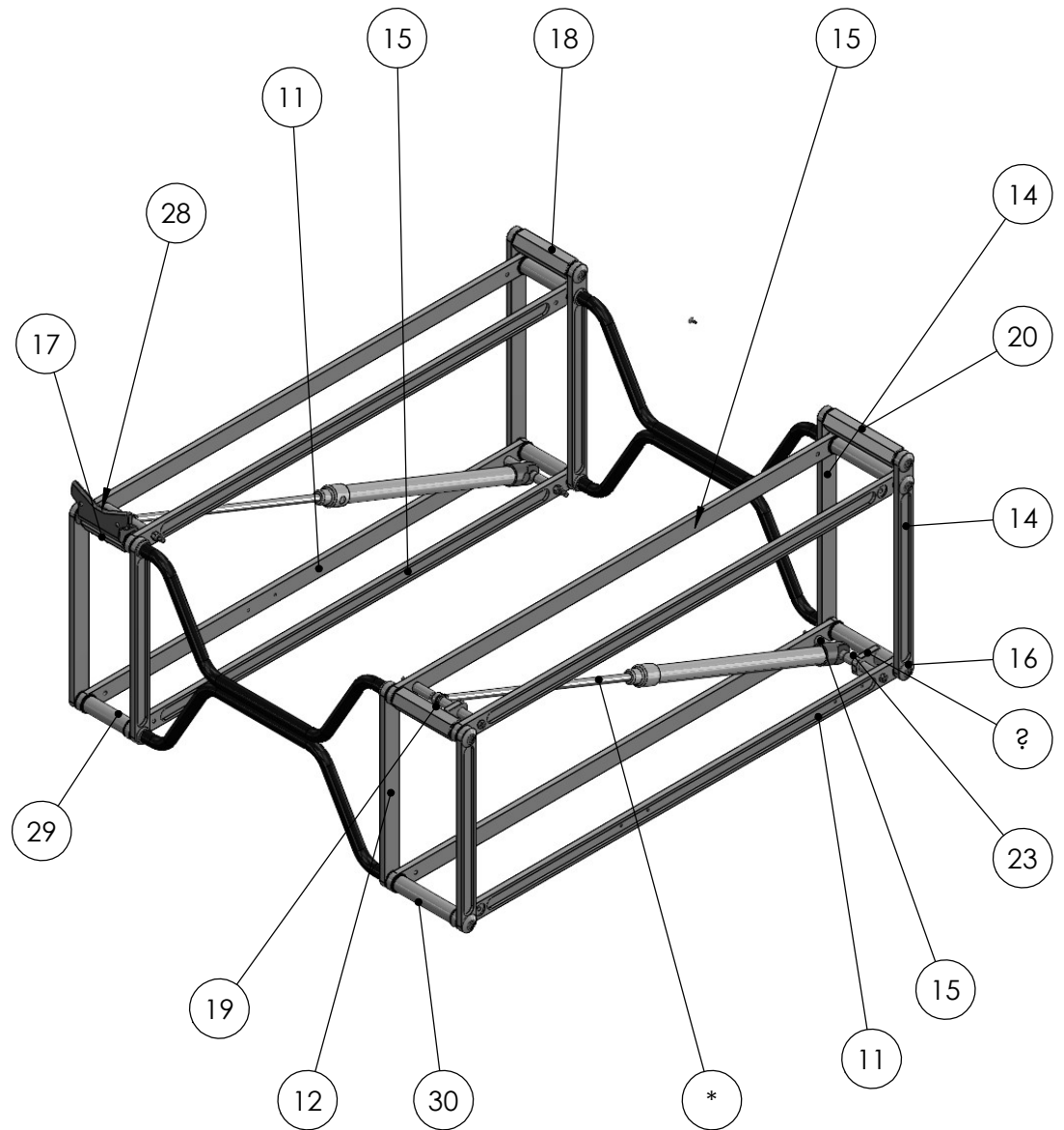

# PART LIBRARY

HEX 7.125

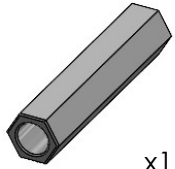

x1

HEX 5.5

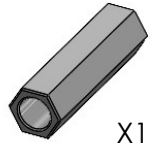

x1

RUNNER 5.875



x3

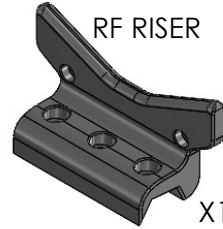

RF RISER

x1

HEX 5.875



x1

HEX 4.250 W/HOLES



x1

RUNNER 4.25

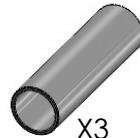

x3

BLACK SPACER



x36

ENDCAP

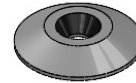

x12

LATE MODEL REAR XBAR

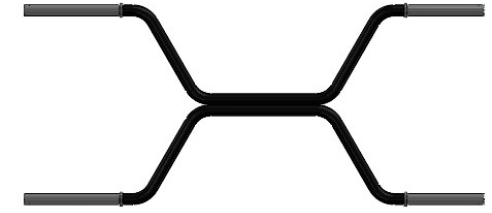

x1

LATE MODEL FRONT XBAR

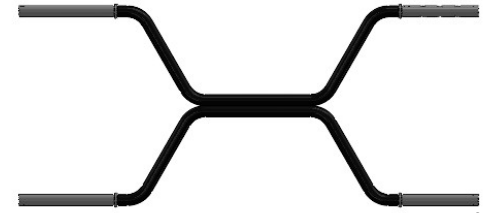

x1

HYDRAULIC SPACER LONG



x1

HYDRAULIC SPACER SHORT



x3

HYDRAULIC SPACER LONG W/GROOVE



x1

HYDRAULIC SPACER SHORT W/GROOVE



x3

5/16-18X2" SOCKET HEAD CAP SCREW    1/4-20X.5" FLAT HEAD CAP SCREW



x3



x12

BOLT SUPPORT RUNNER



x1

BOLT SUPPORT 3/8-16 LOCKNUT



x1

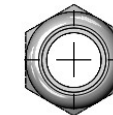

x4



x4

HYDRAULIC CYLINDERS



x2

3/8-16X8"



x2

3/8-16X6.5"



x2

ECO LONG BAR



x2

ECO THREADED LONG BAR



x4

ECO HANDLE LONG BAR



x2

ECO LADDER



x4

ECO REAR LADDER



x4

## BEFORE YOU BUILD

- THIS DOES REQUIRE GREASE. ANY CHASSIS OR BEARING GREASE
- SORT PARTS TO MAKE IT EASIER TO ASSEMBLE
- GET ALL THE TOOLS YOU NEED
  - 1/4 ALLEN WRENCH KEY
  - 3/16 ALLEN WRENCH KEY
  - 5/32 ALLEN WRENCH KEY
  - 1/8 ALLEN WRENCH KEY
  - 1/2 WRENCH
  - 9/16 WRENCH
  - 1/4 WRENCH
  - RUBBER Mallet
  - FLATHEAD SCREWDRIVER ANY SMALL SIZE
- MAKE SURE YOU HAVE A CLEAN WORKSPACE
- BE SURE TO GREASE BLACK SPACERS AND LADDER OPENING
- APPLY RED THREAD LOCK WHEN DIRECTED

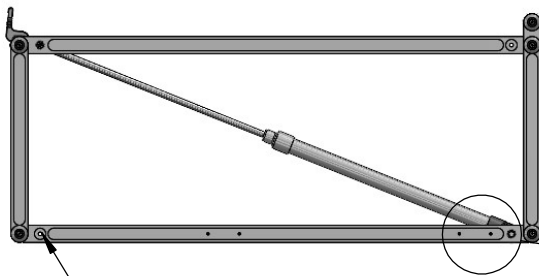
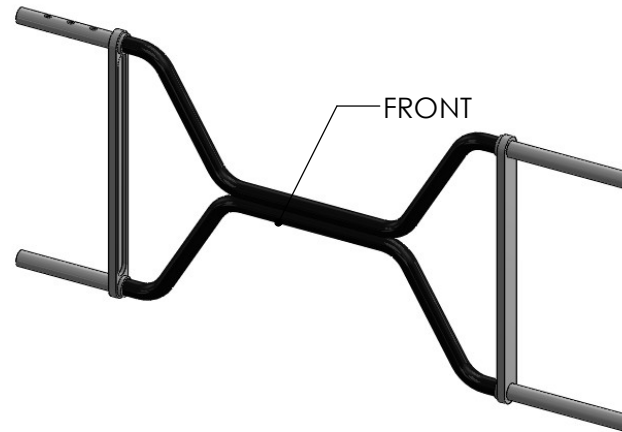
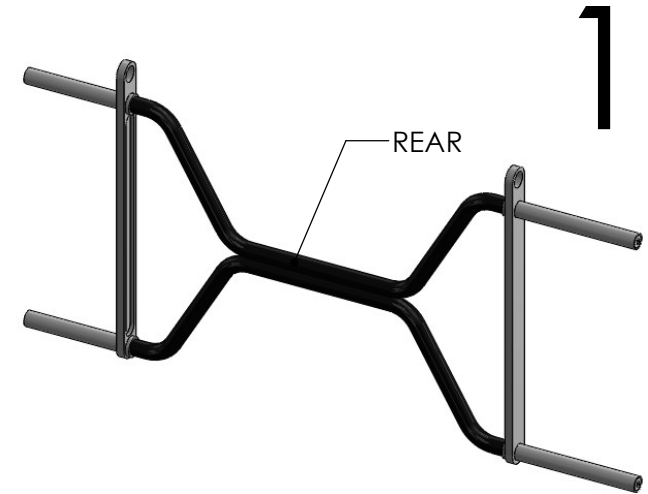

BORE FACES THE FRONT FOR THE **ECO HANDLE LONG BAR** AND THE BACK FOR THE **ECO LONG BAR**, WHEN ASSEMBLING DOUBLE CHECK ORIENTATION OF THIS LONG BAR

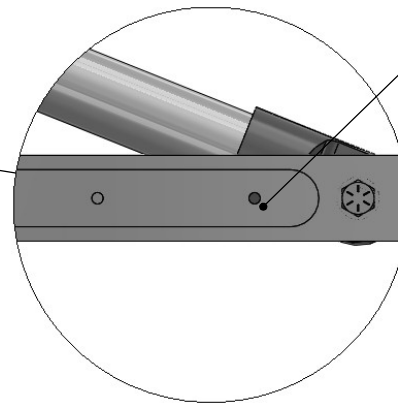

HANDLE HOLES POINT TOWARDS THE REAR

2

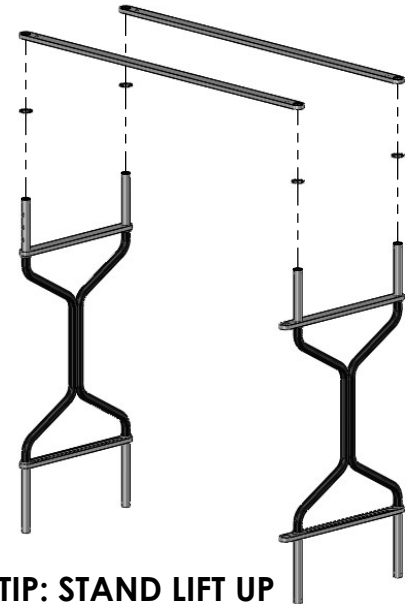
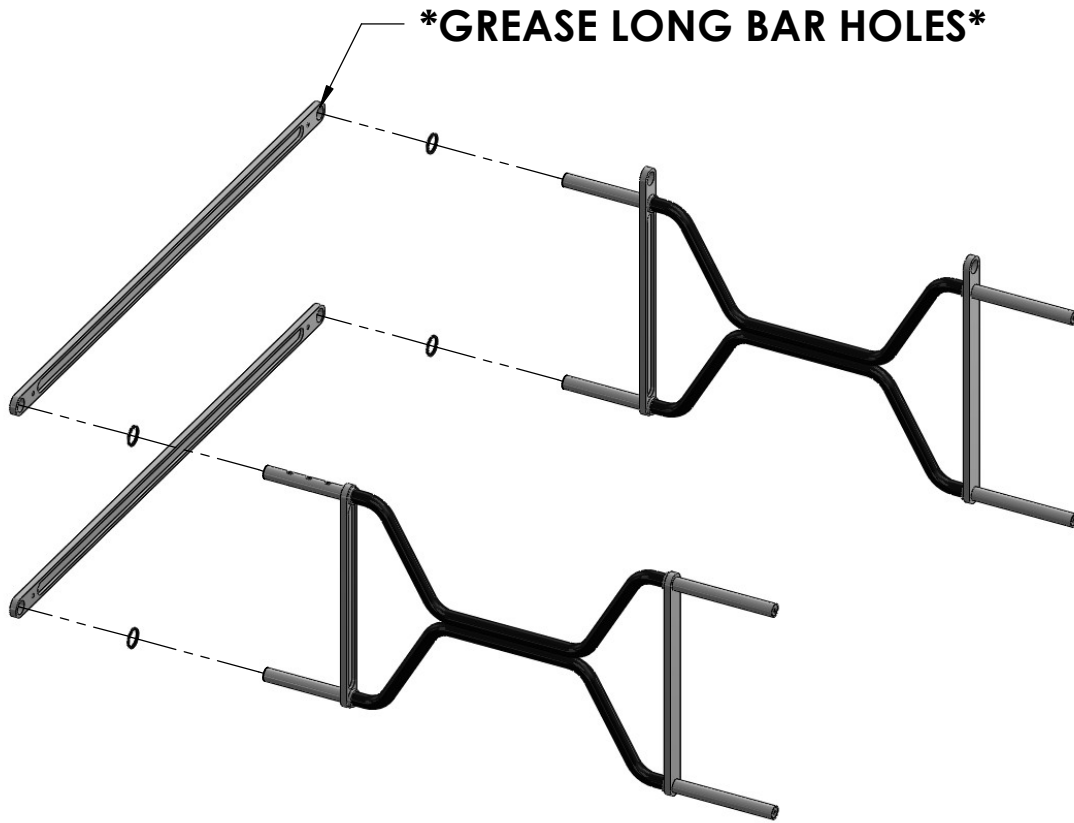

TIP: STAND LIFT UP

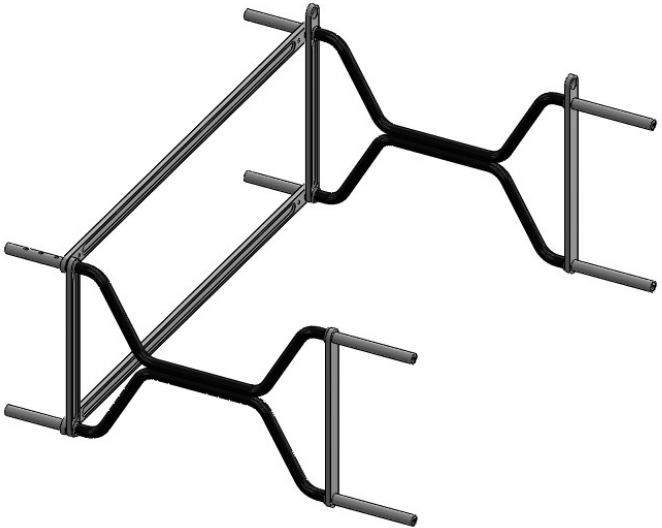

BLACK SPACER  
ECO THREADED LONG BAR



**TIP: KEEP LIFT STANDING UP,  
MAKE SURE THE LIFT IS  
BEING BUILT IN THE RIGHT  
ORIENTATION.**

3

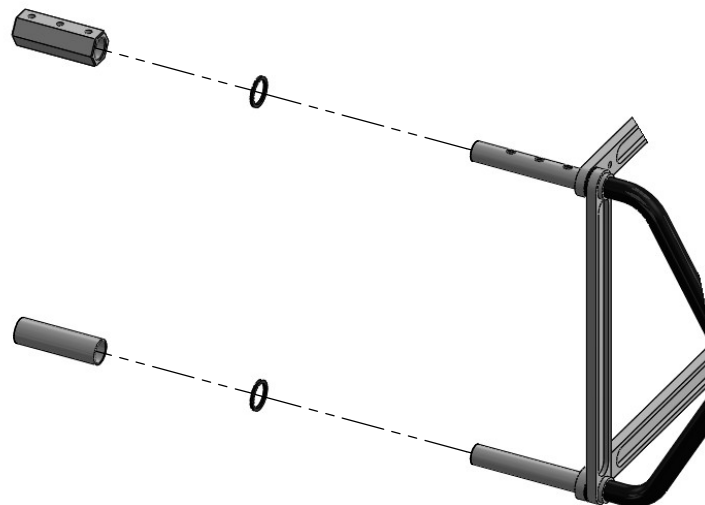
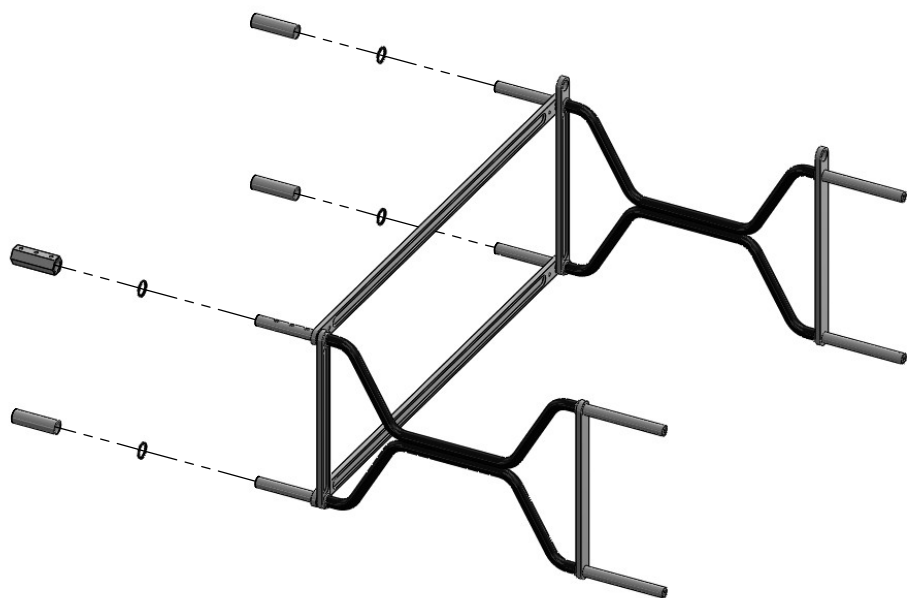

BLACK SPACER  
HEX W/HOLES 4.25  
RUNNER 4.25



X4



X1



X3

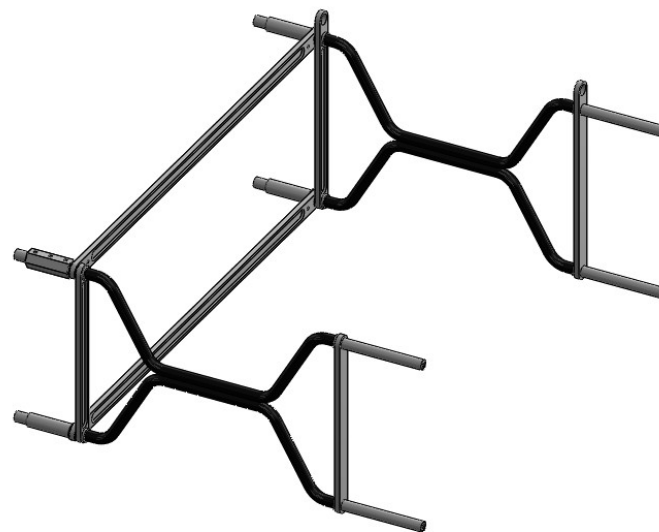

4

**\*GREASE LONG BAR HOLES\***

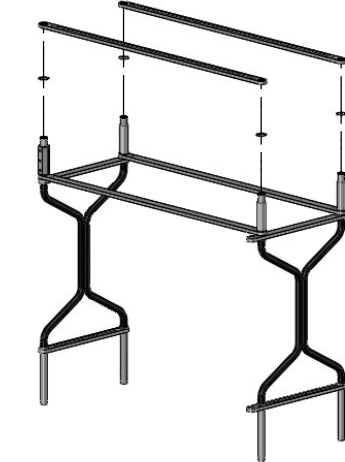
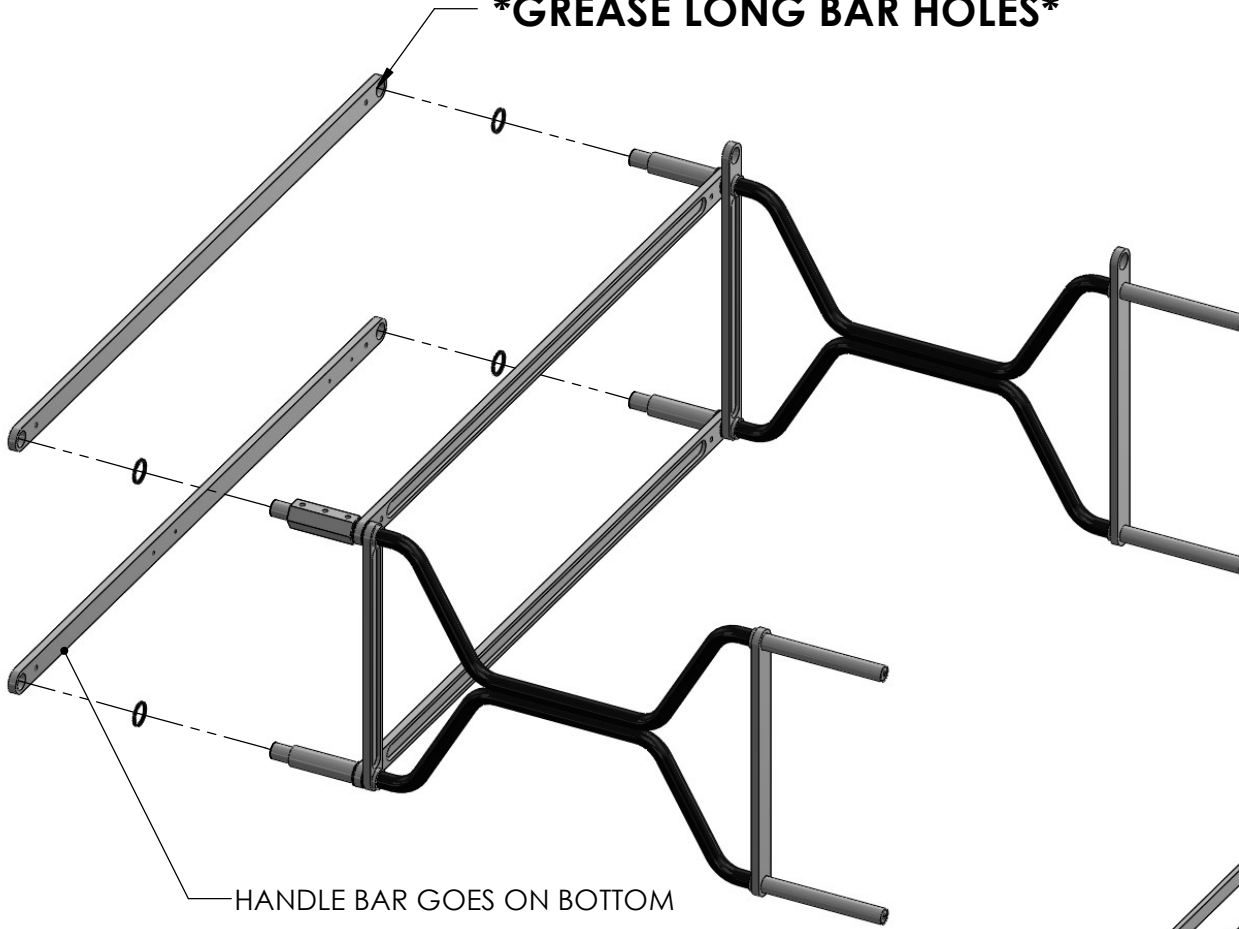

**TIP: STAND LIFT UP**

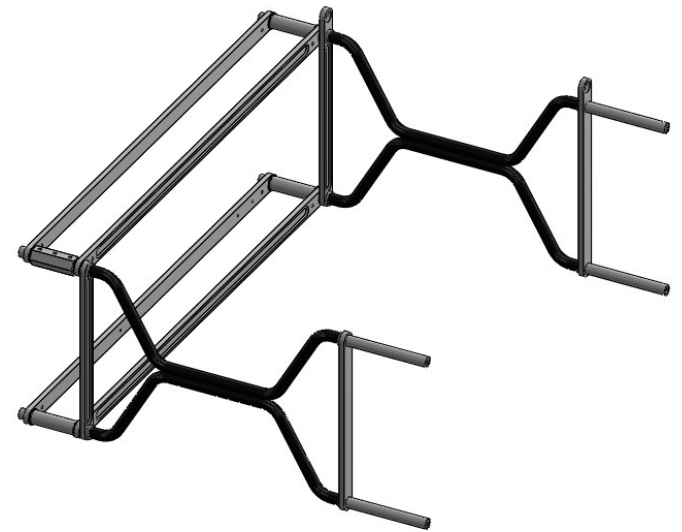

BLACK SPACER  
ECO LONG BAR  
ECO HANDLE LONG BAR



X4



X1



X1

**TIP: KEEP LIFT STANDING UP,  
MAKE SURE THE LIFT IS  
BEING BUILT IN THE RIGHT  
ORIENTATION.**

5

LEAVE FLATHEAD  
SCREWS LOOSE UNTIL  
HYDRALUIC CYLINDERS  
ARE FULLY INSTALLED

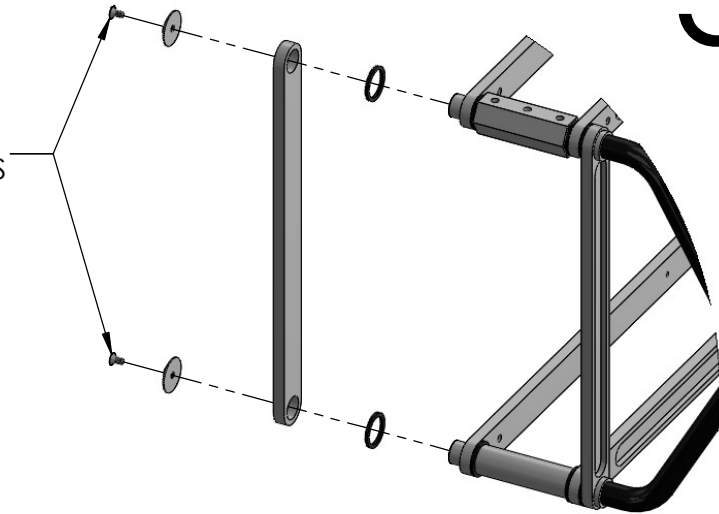
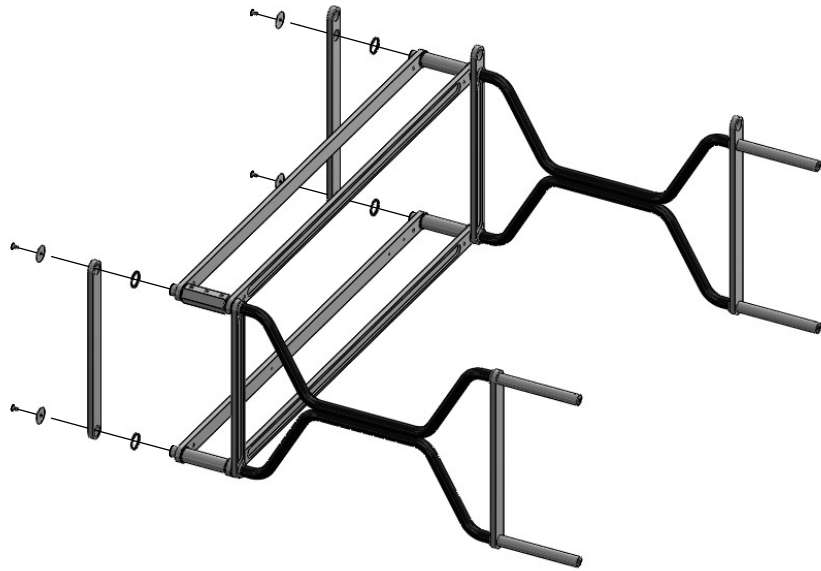

1/4-20X.625" FLAT HEAD SCREW (1:1 SCALE)  
BLACK SPACER  
ENDCAPS  
ECO LADDER  
ECO REAR LADDER

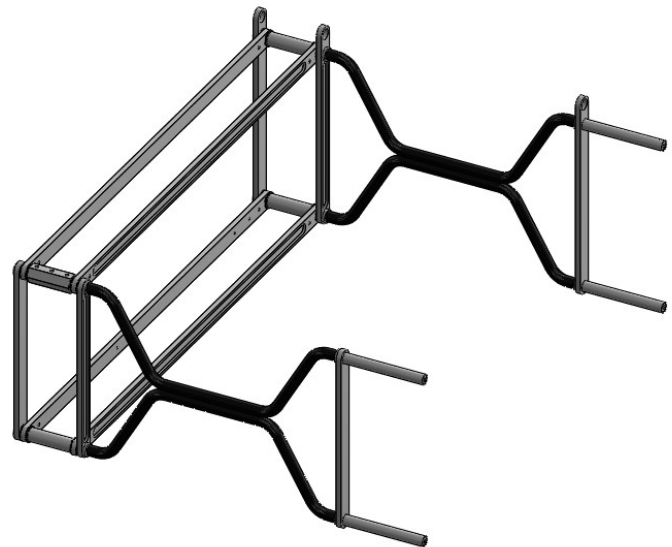
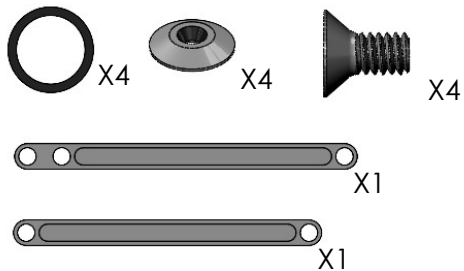

**\*GREASE LONG BAR HOLES\***

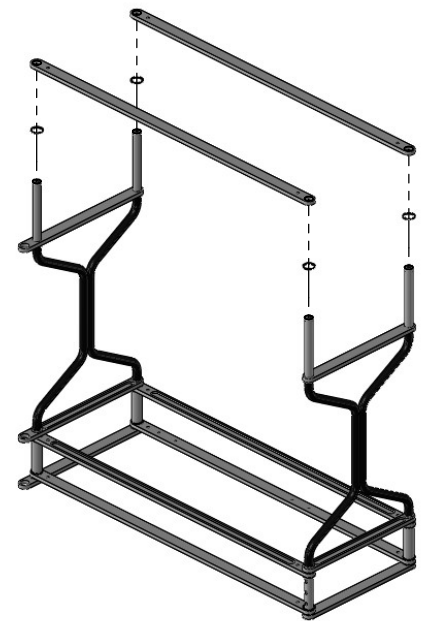
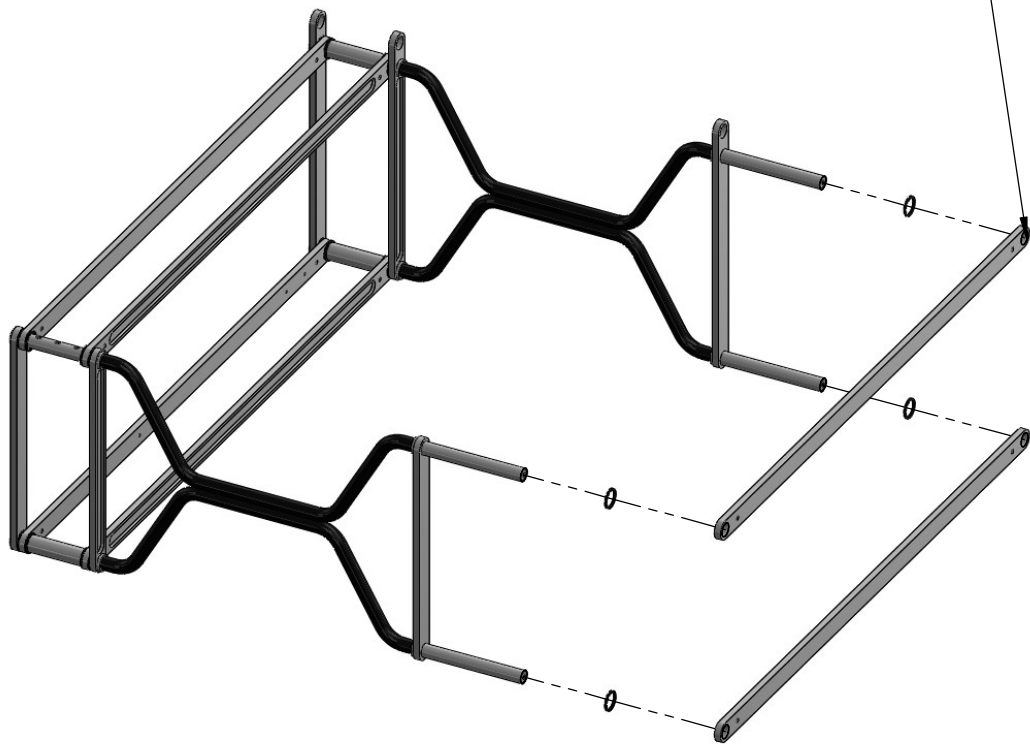

**6**

**TIP: STAND LIFT UP**

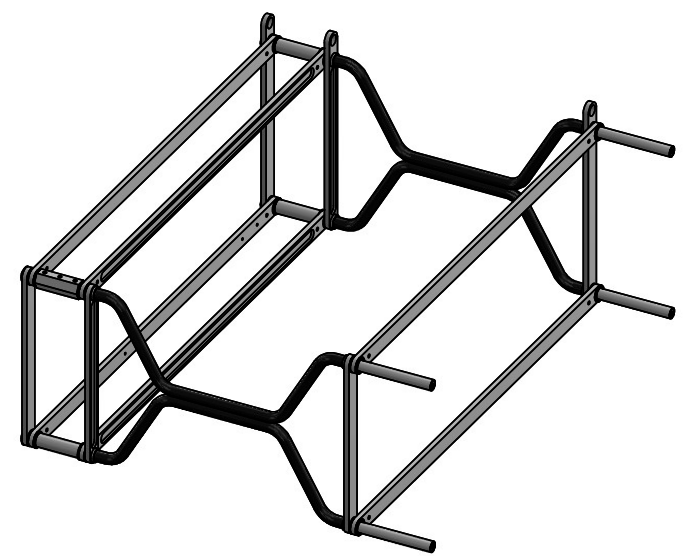

BLACK SPACER  
ECO THREADED LONG BAR



X4



X2

**TIP: KEEP LIFT STANDING UP,  
MAKE SURE THE LIFT IS  
BEING BUILT IN THE RIGHT  
ORIENTATION.**

**7**

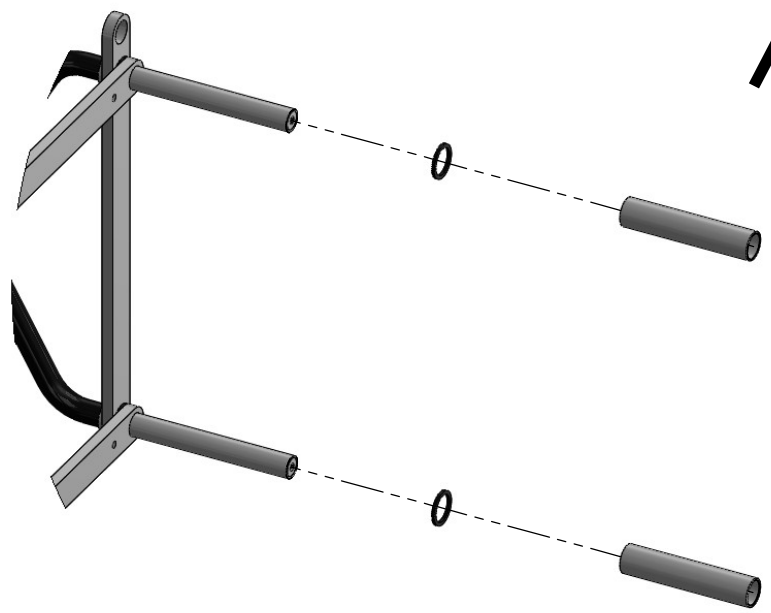
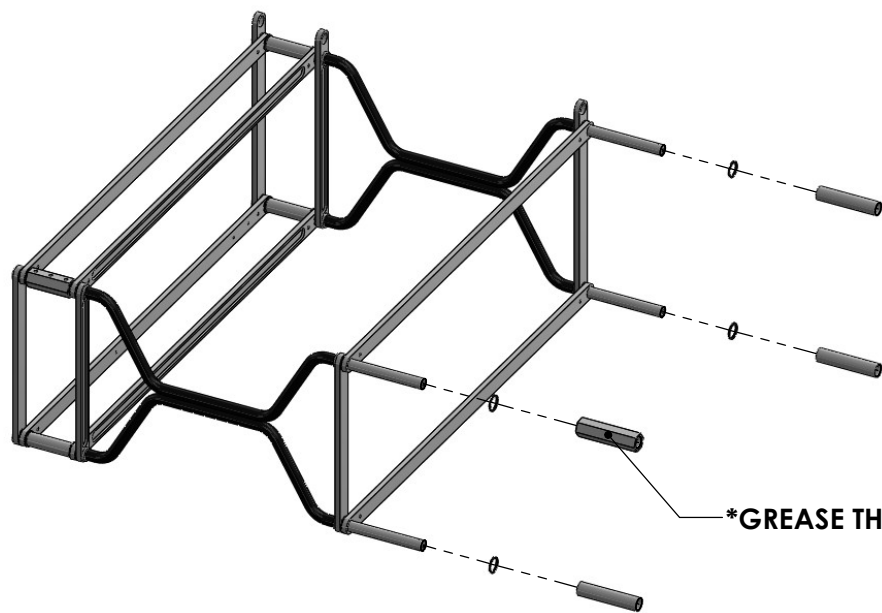

**\*GREASE THE HEX OPENINGS\***

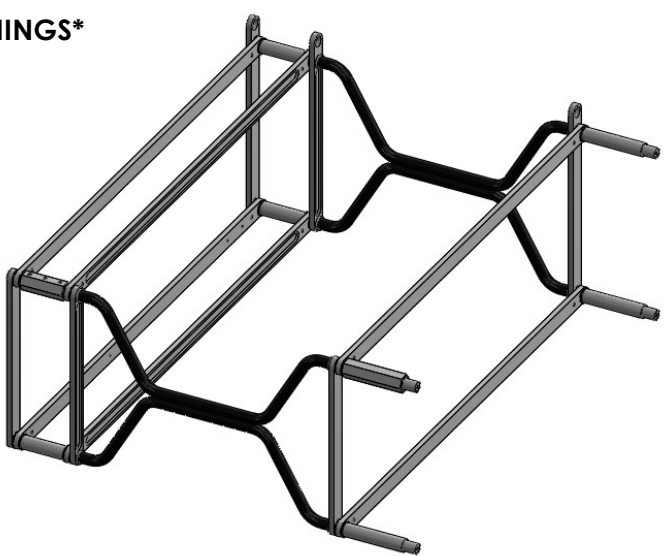

BLACK SPACER  
HEX 5.875  
TUBE SPACER 5.875



X4

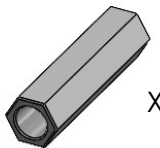

X1



x3

8

**\*GREASE LONG BAR HOLES\***

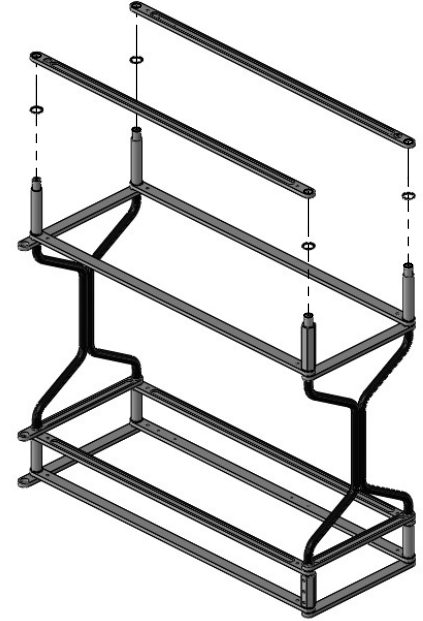
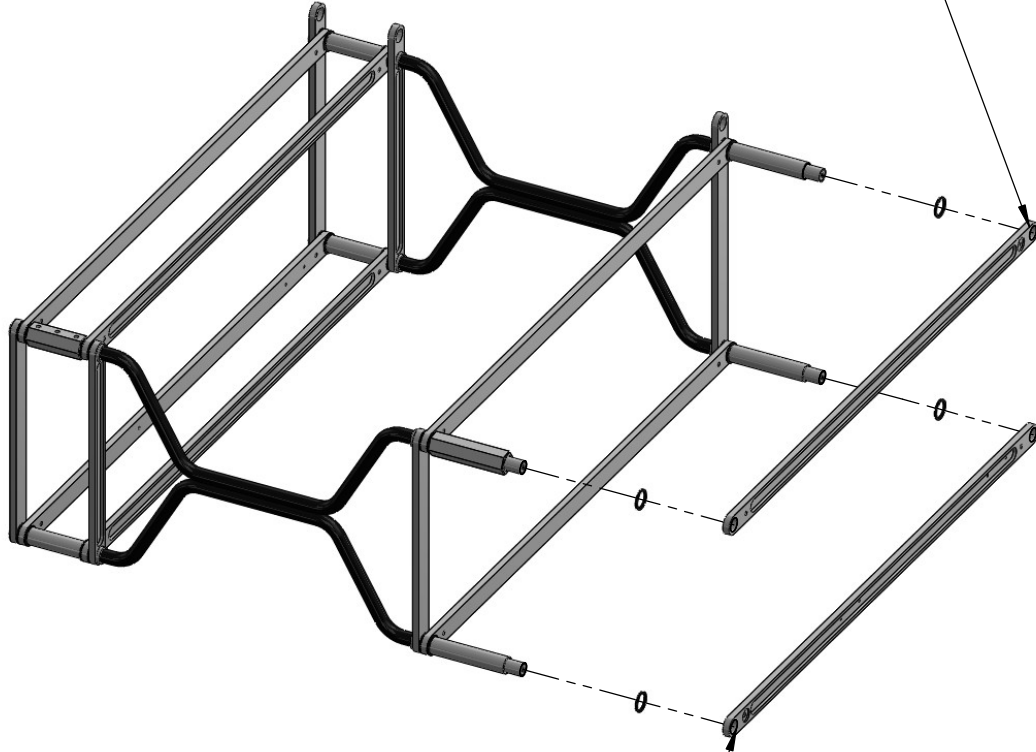

**TIP: STAND LIFT UP**

HANDLE LONG LADDER GOES ON BOTTOM

BLACK SPACER  
ECO LONG LADDER  
ECO HANDLE LONG LADDER



X4



X1



X1

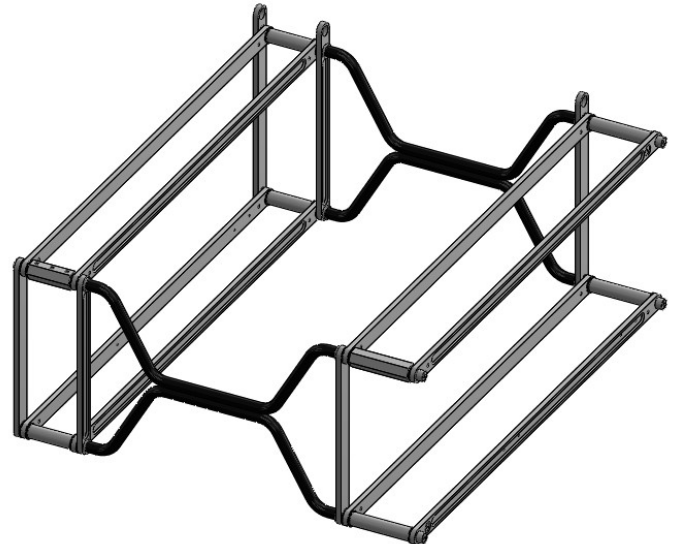

**TIP: KEEP LIFT STANDING UP,  
MAKE SURE THE LIFT IS  
BEING BUILT IN THE RIGHT  
ORIENTATION.**

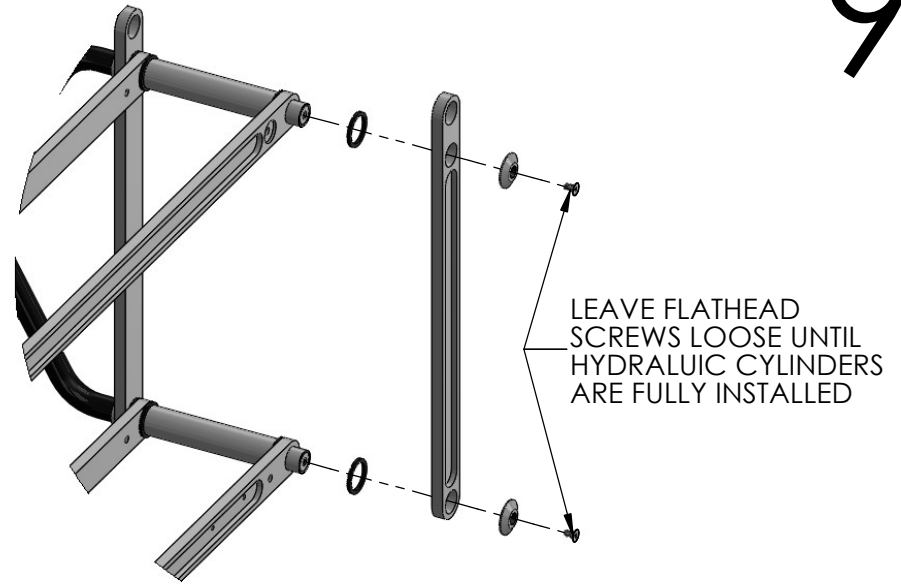
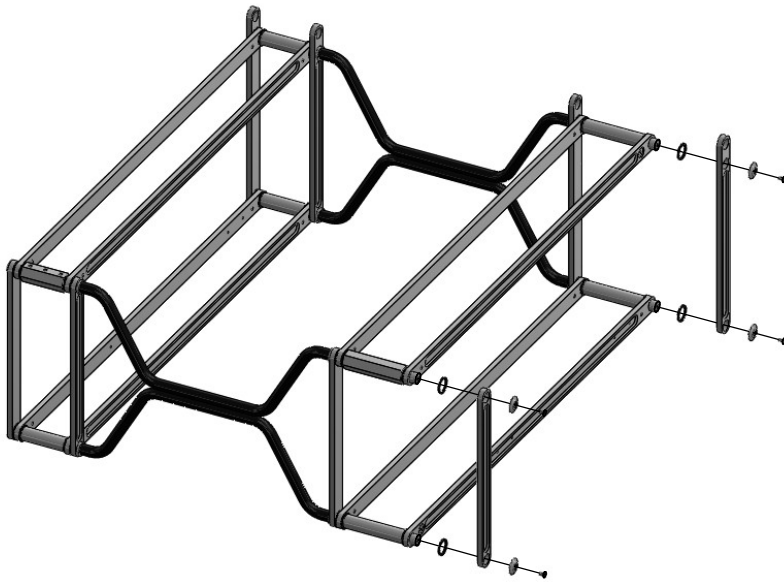

- 1/4-20X.625" FLAT HEAD SCREW (1:1 SCALE)
- BLACK SPACER
- ENDCAPS
- ECO LADDER
- ECO REAR LADDER

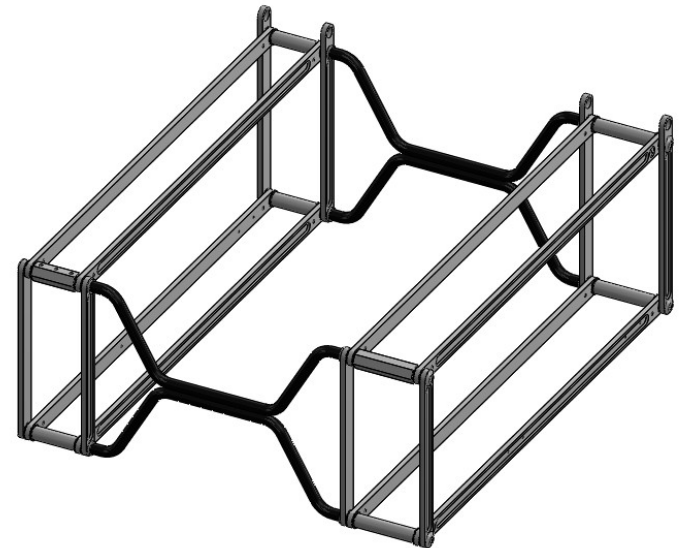
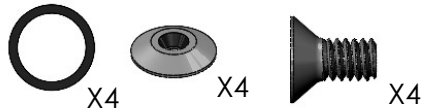

# 10

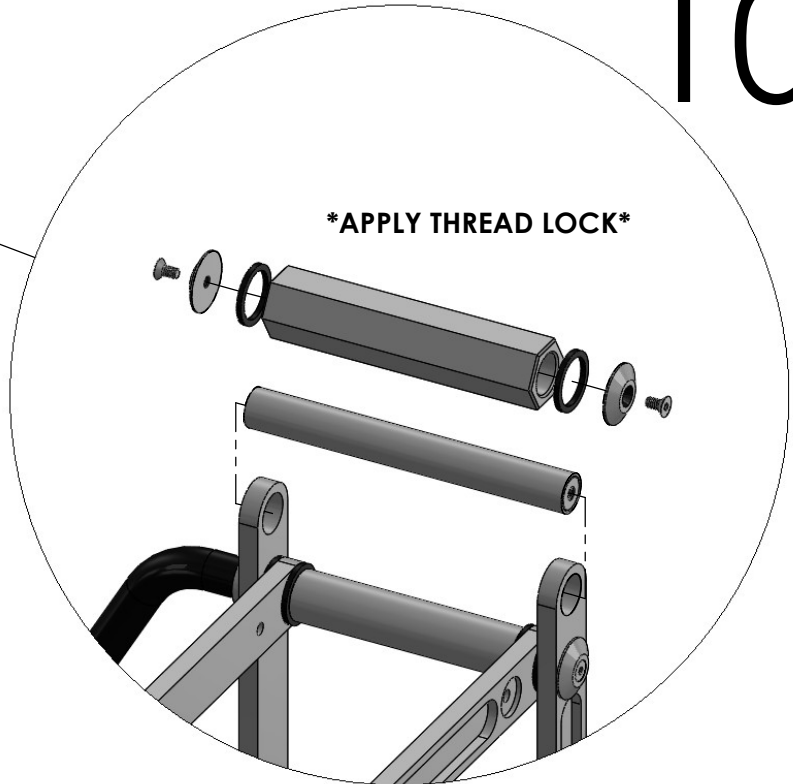
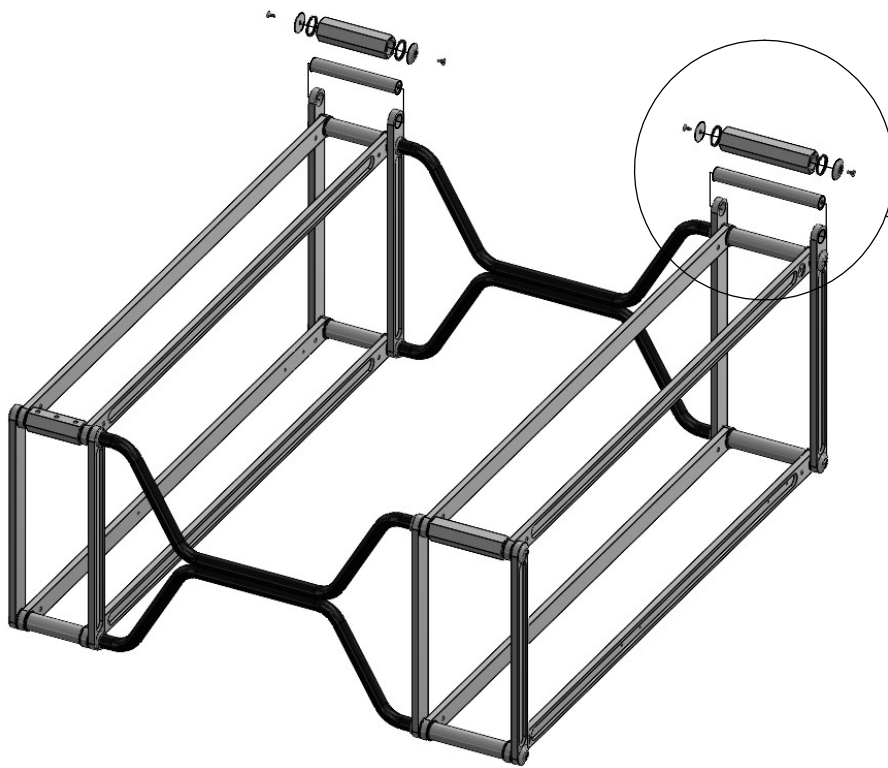

- 1/4-20X.5 FLAT HEAD SCREW 1:1 SCALE
- HEX 5.5
- HEX 7.125
- STEEL SUPPORT 6.75
- STEEL SUPPORT 8.375
- BLACK SPACER
- END CAP

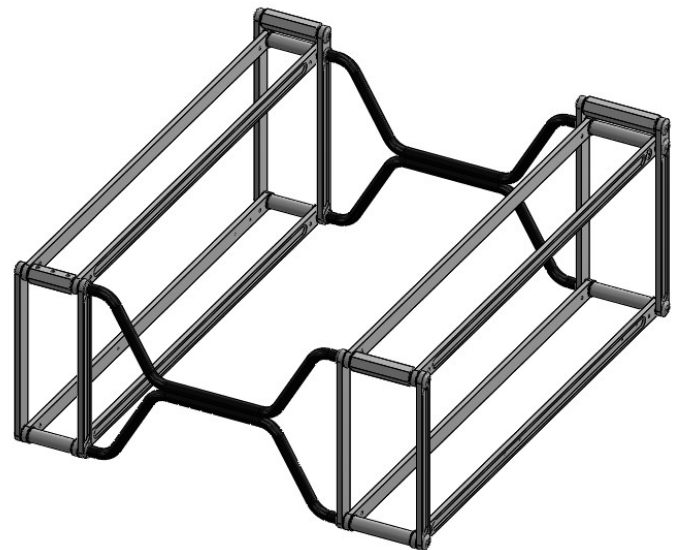
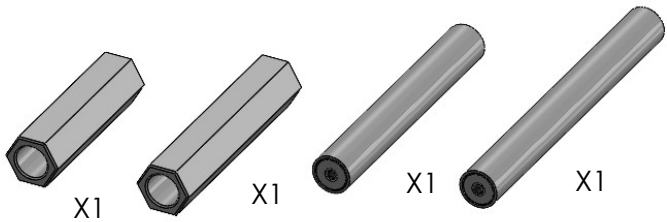
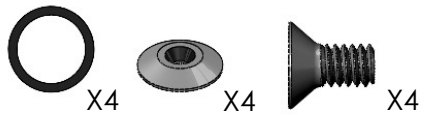

**\*APPLY THREAD LOCK\***

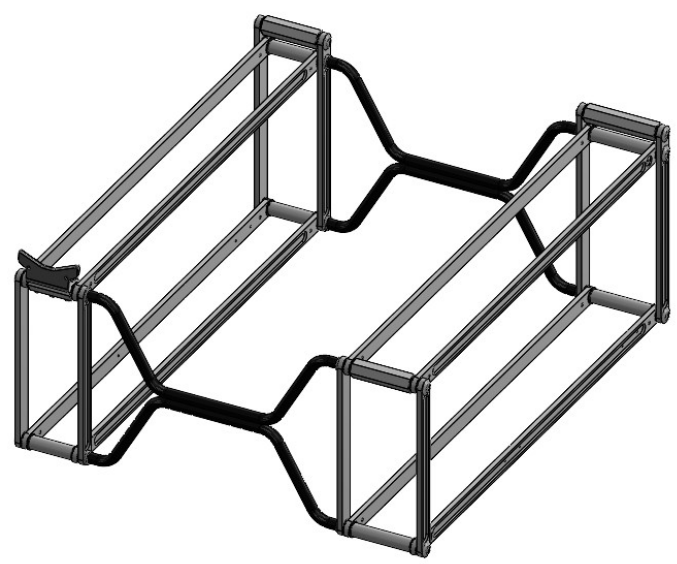
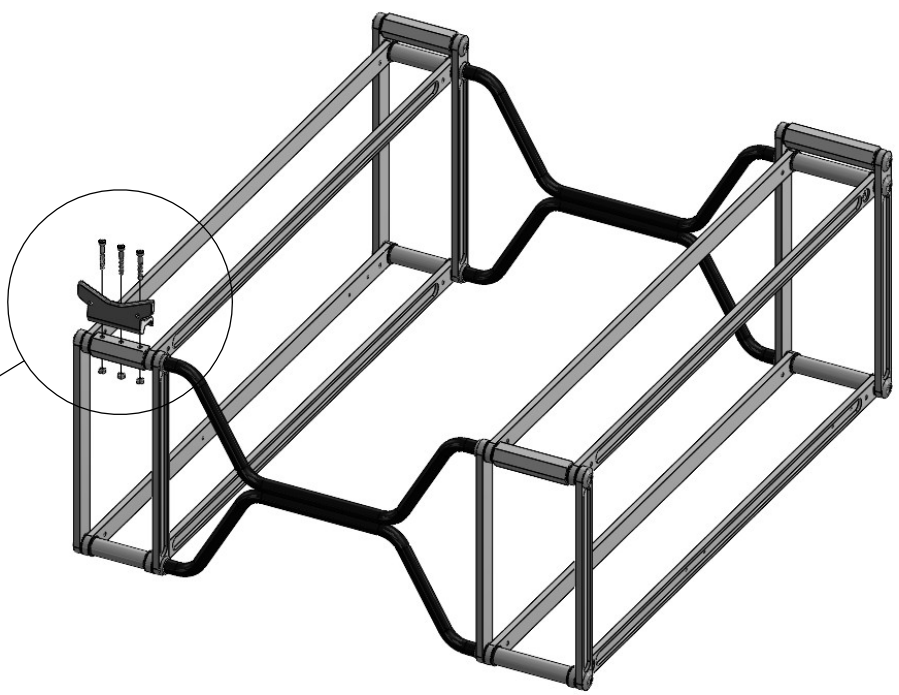
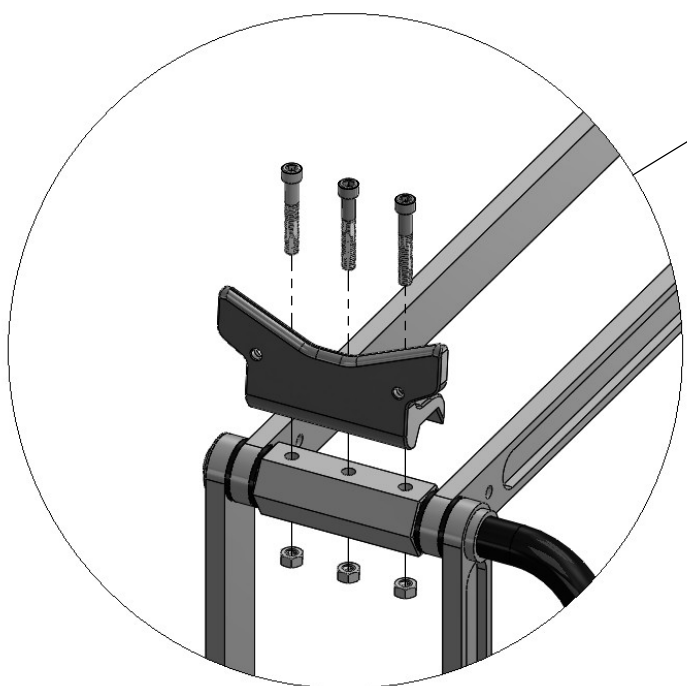

RF RISER  
5/16-18X2" SOCKET HEAD CAP SCREW  
5/16-18 NUT

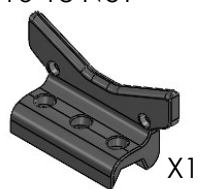

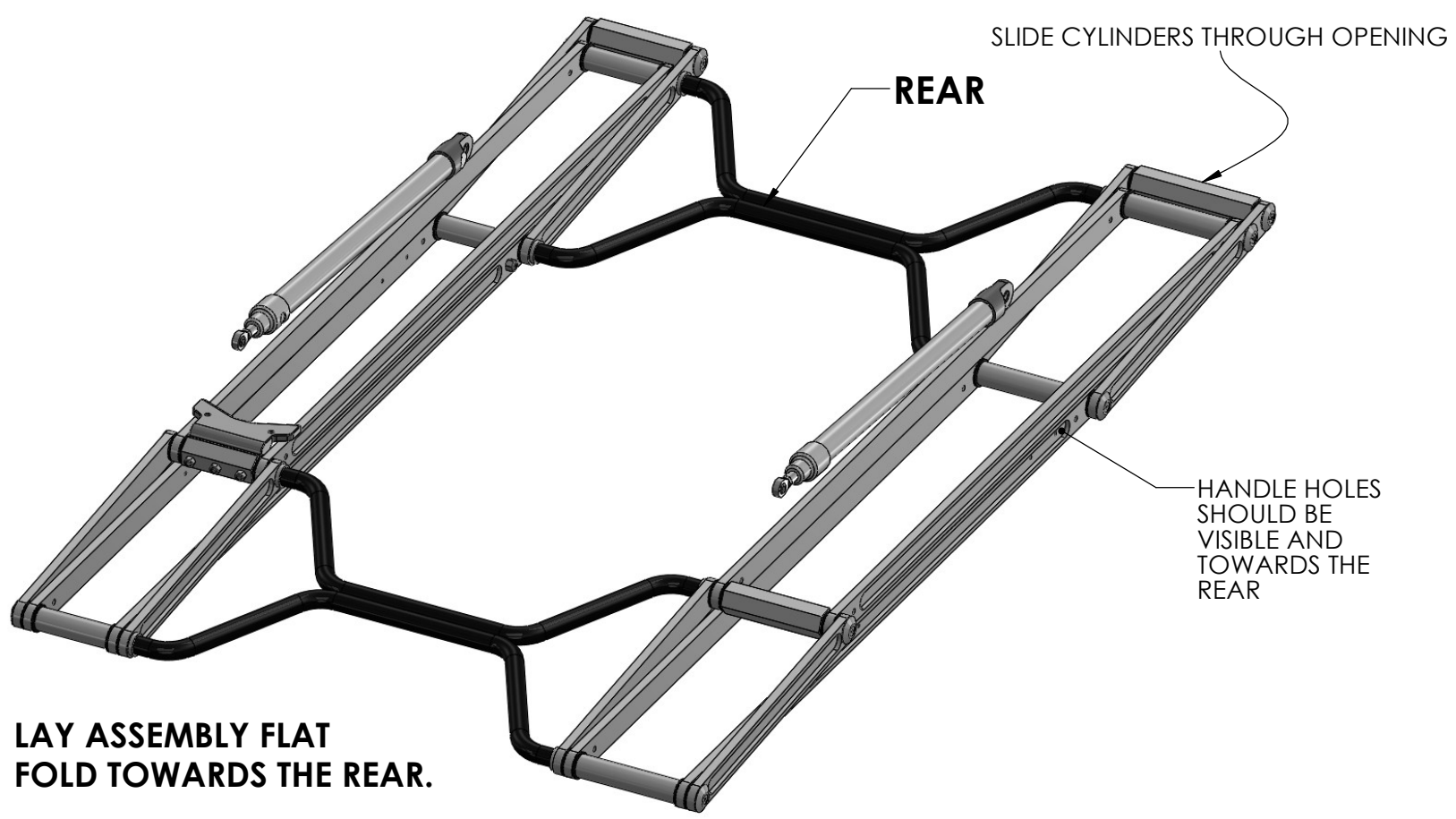

**LAY ASSEMBLY FLAT  
FOLD TOWARDS THE REAR.**

HYDRAULIC CYLINDER



X2

**\*THIS IS A CRITICAL STEP \***

**ASSEMBLE BOTTOM FIRST OF THIS STEP THEN REFER TO STEP 14 BEFORE FINISHING THE TOP PART OF THIS STEP.**

**TIGHTEN JAM NUT ON HEIM AFTER SETTING THE LENGTH**

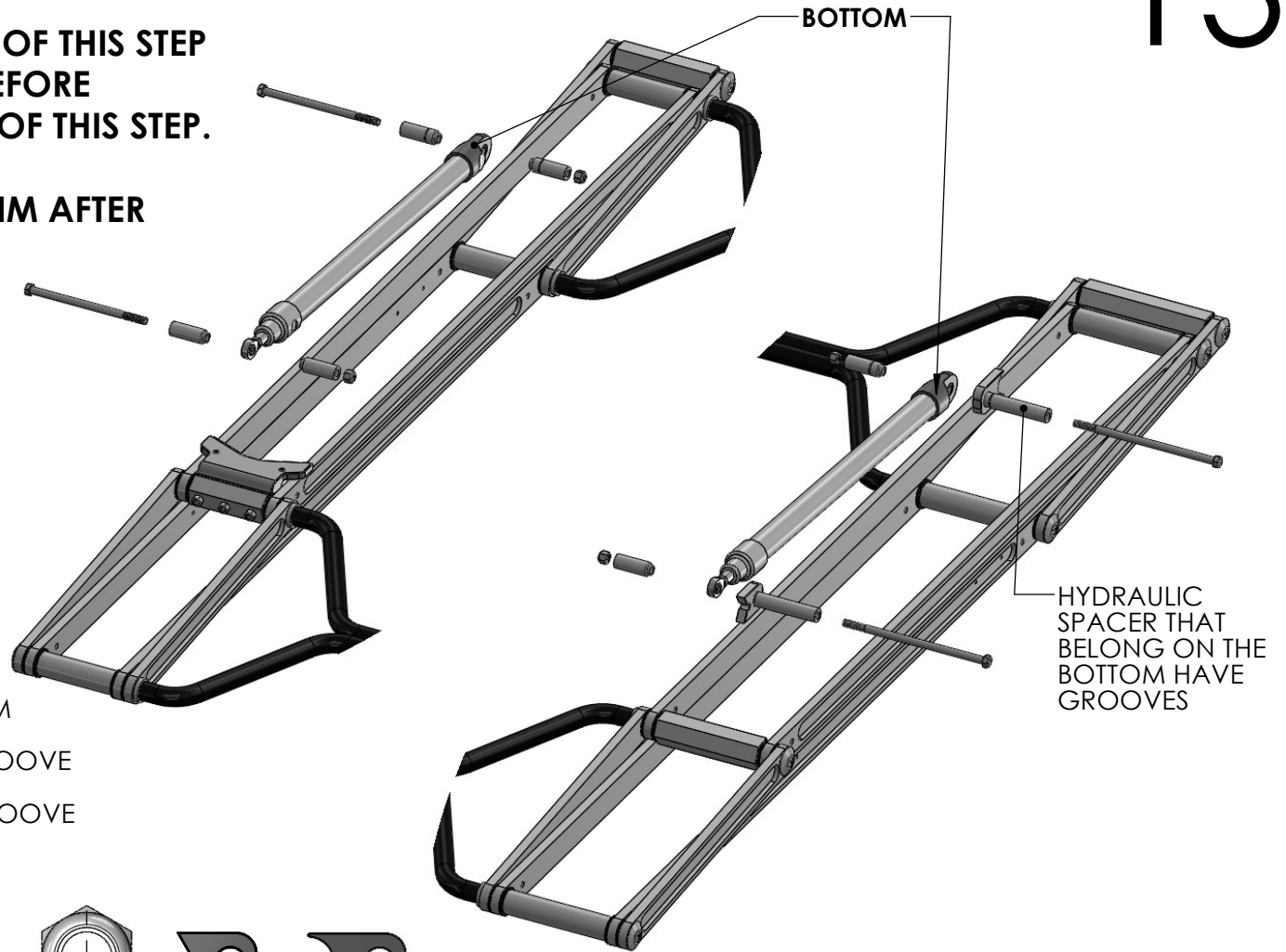

- 3/8-16X8" HEX HEAD SCREW
- 3/8-16X6.5" HEX HEAD SCREW
- 3/8-16 LOCKNUT
- CYLINDER BOLT SUPPORTS BOTTOM
- CYLINDER BOLT SUPPORTS TOP
- HYDRAULIC SPACER LONG W/GROOVE
- HYDRAULIC SPACER LONG
- HYDRAULIC SPACER SHORT W/GROOVE
- HYDRAULIC SPACER SHORT
- HYDRAULIC CYLINDER

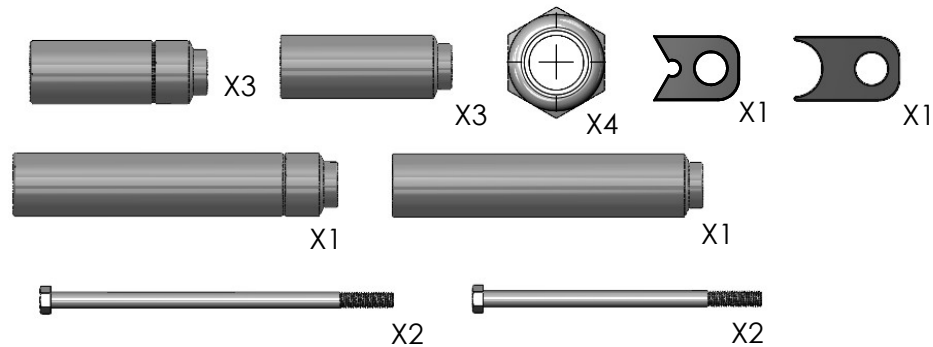

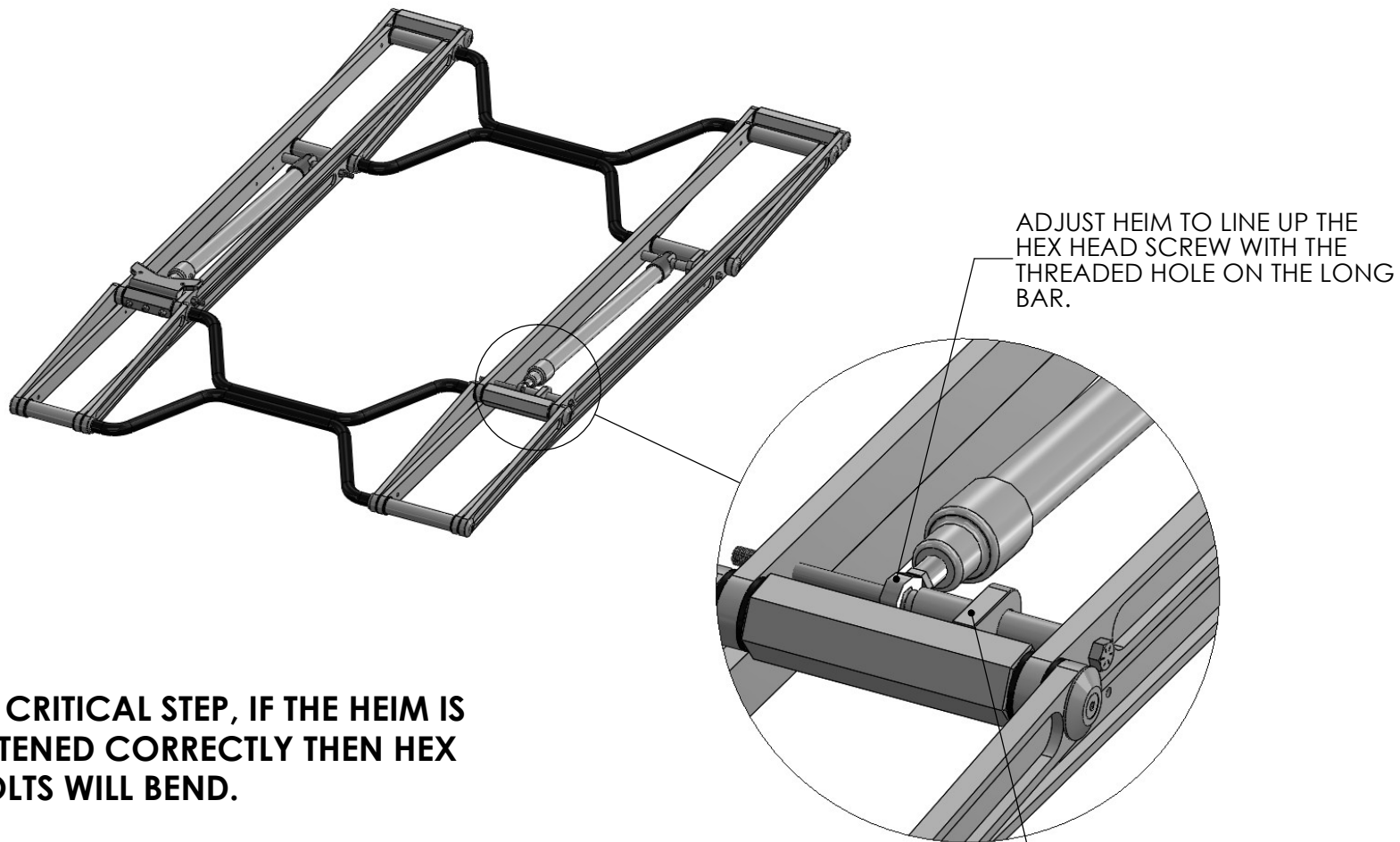

ADJUST HEIM TO LINE UP THE HEX HEAD SCREW WITH THE THREADED HOLE ON THE LONG BAR.

**THIS IS A CRITICAL STEP, IF THE HEIM IS NOT FASTENED CORRECTLY THEN HEX HEAD BOLTS WILL BEND.**

**FULLY CONTRACT CYLINDER (SHORTEST LENGTH POSSIBLE) BEFORE SETTING THE HEIM LENGTH SO THE BOLT WILL LINE UP.**

**\*\*DO NOT PULL CYLINDER ROD OUT.\*\***

SET SCREW ON BOLT SUPPORTS NEEDS TO FACE THE BOTTOM. THE BOLT SUPPORT ALSO NEEDS TO ALIGN IN THE MIDDLE OF THE HEX HEAD SCREW.

15



\*APPLY **RED** THREAD LOCK TO ENDCAP BOLTS AND TIGHTEN STEPS FIVE AND NINE\*

# HANDLE ASSEMBLY

ITEM NO.	PART NUMBER	QTY.
1	1/4-20 LOCKNUT	2
2	1/4-20X.5" FLATHEAD SCREW	10
3	1/4-20X1.75 SOCKETHEAD CAP SCREW	2
4	5-40 LOCKNUT	2
5	5-40X1.25" BRASS ROUND HEAD SLOTTED SCREW	2
6	CROSSBAR	1
7	HANDLE BAR	1
8	HANDLE BASE	2
9	HANDLE HINGE	2
10	HANDSTRAP	2

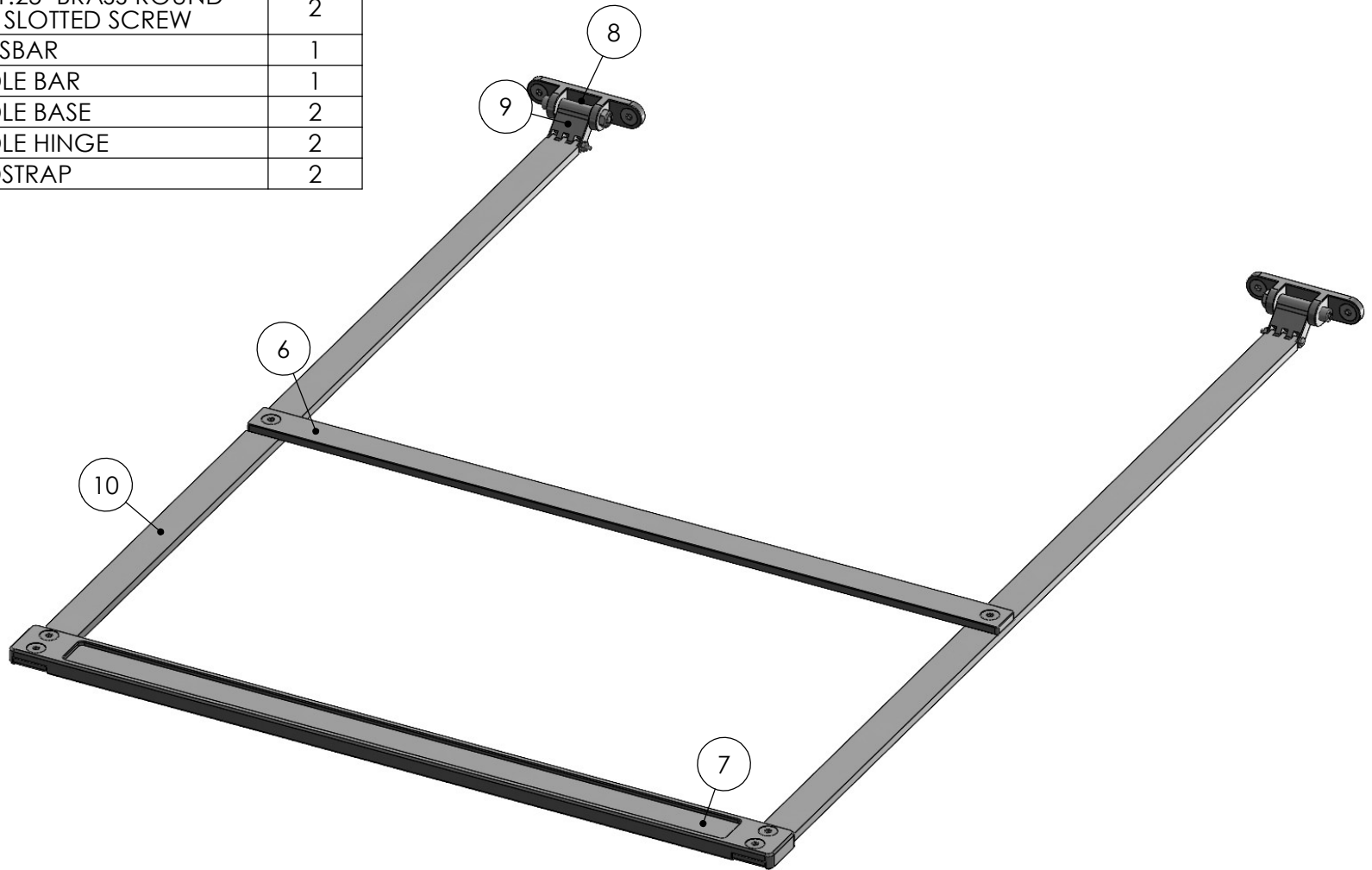

**\*ADD THREAD LOCKER TO ALL FLAT HEADS\***

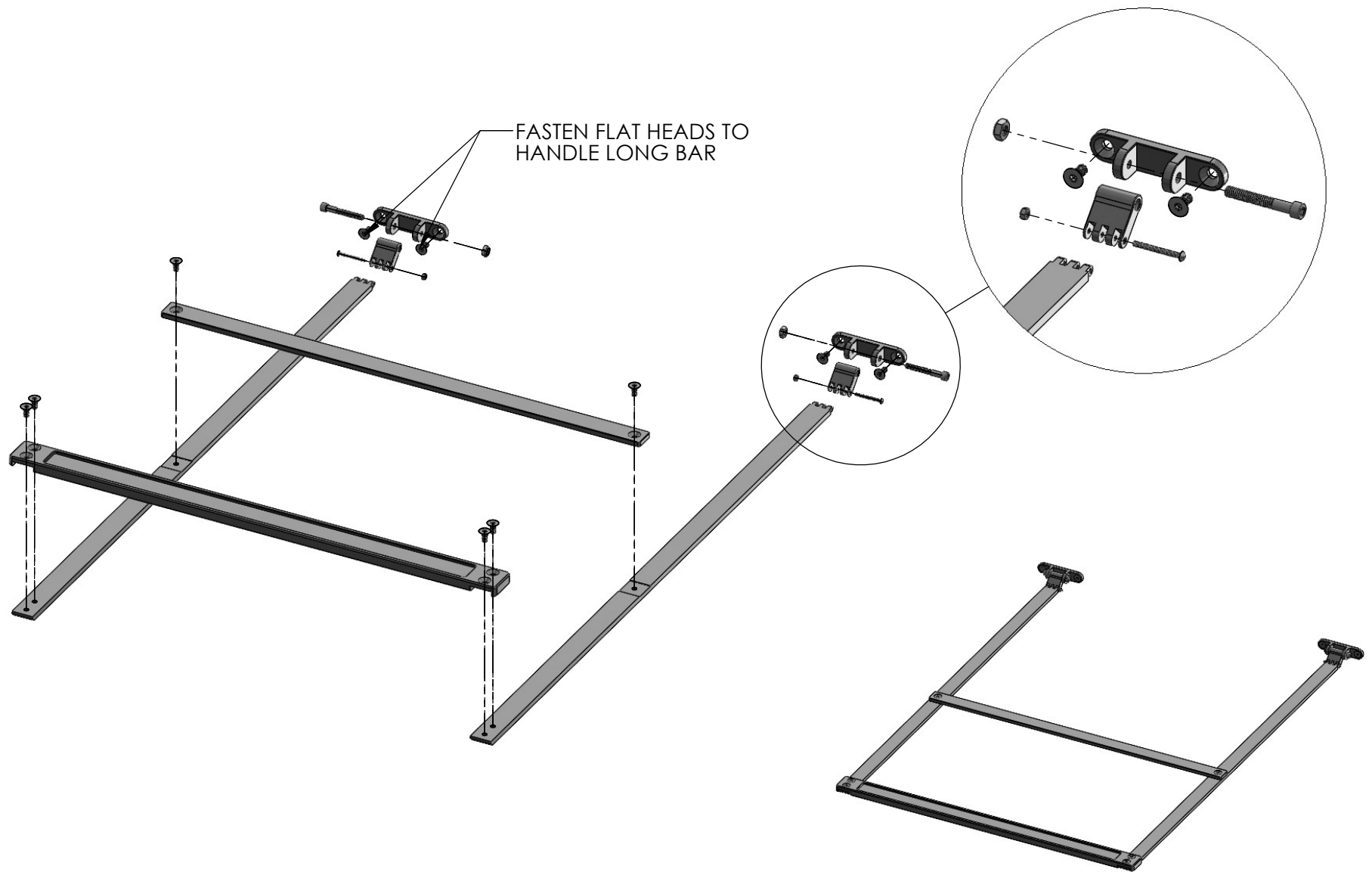

2

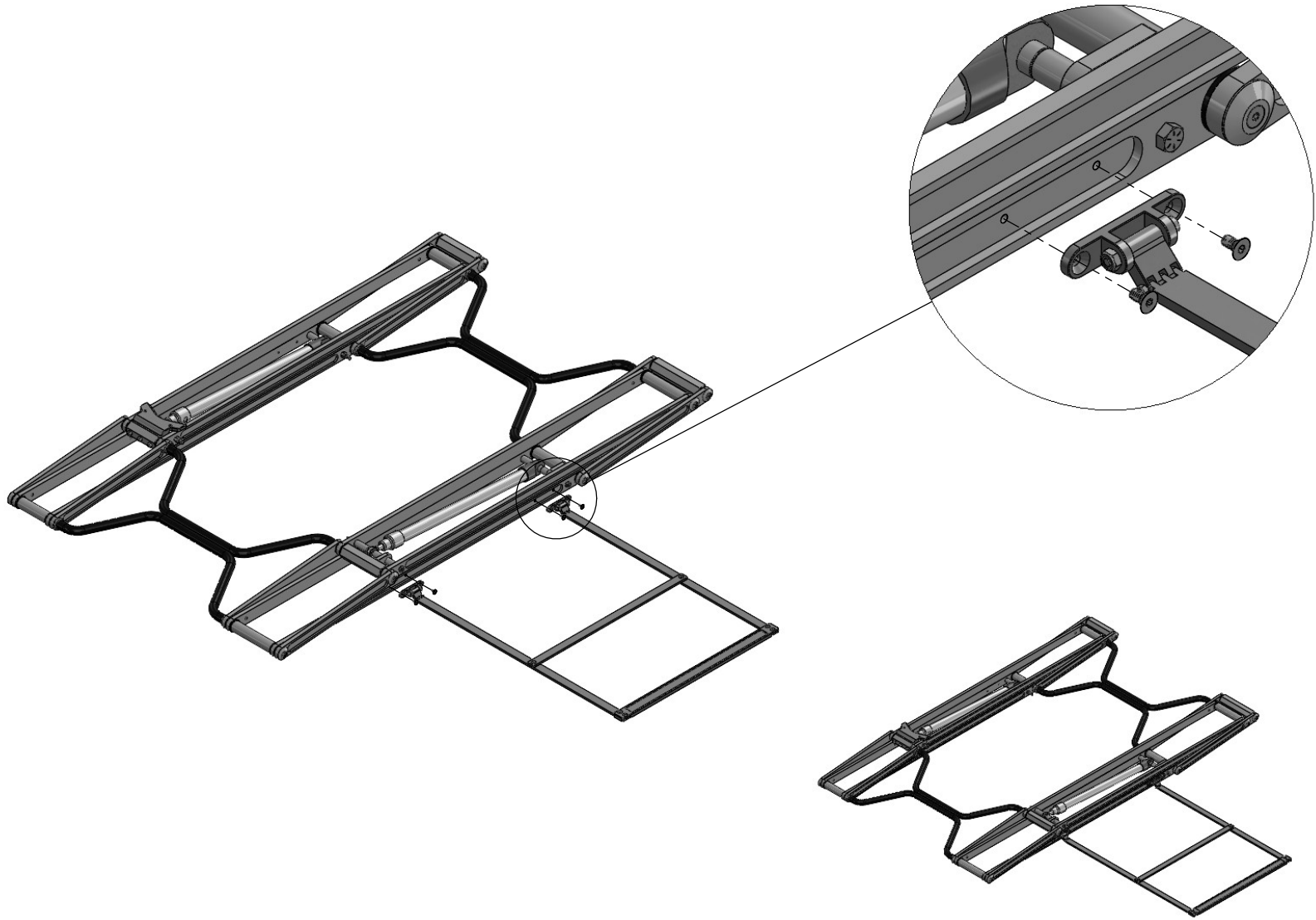

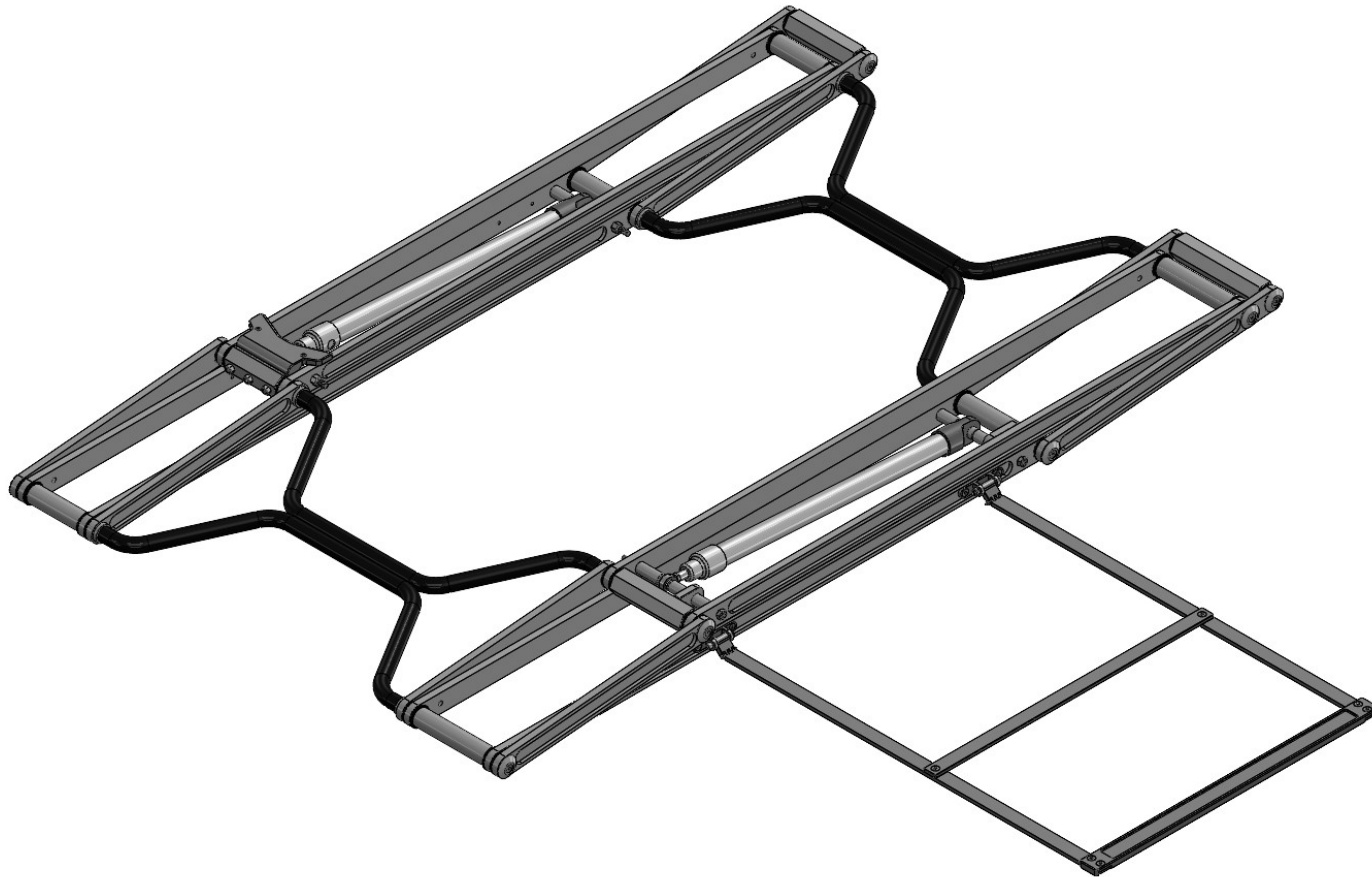

**\*\*DO NOT USE BEFORE READING CAUTION PAGE\*\***

# FAQ



## BATTERY SPECIFICATIONS

LENGTH; 7.75" WIDTH 5.125" HEIGHT: 7.25"

CRANKING AMPS; 430

CCA; 340-350

BATTERIES PLUS PART # **SLADC12-35J**

NAPA PART # **BAT 8227**

ADVANCE AUTO PART **U1-2**

HYDRAULIC OIL 1-GALLON PREMIUM CLEAR  
AW32 OR BETTER

**DO NOT USE** ATF (AUTOMATIC TRANSMISSION  
FLUID) OR ANY RED FLUID OF ANY TYPE  
THIS WILL VOID THE WARRANTY ON THE  
CYLINDERS/ PUMP/ HOSES /ETC.

## WHAT ARE THE LIFTING CAPABILITIES?

4500LBS

## WHAT HYDRAULIC SYSTEM DO YOU USE?

POWER UP/ POWER DOWN HYDRAULIC  
SYSTEM

## CAN I WASH MY CAR ON THE LIFT?

YES, BUT DO NOT PUT DIRECT WATER  
PRESSURE ON THE CYLINDER SEALS

## CAN I LEAVE MY CAR ON THE LIFT DURING THE WEEK?

YES. THERE IS NO LIMIT TO THE DURATION  
OF TIME THE CAR CAN STAY ON THE LIFT

## HOW MUCH DOES THE LIFT WEIGH?

67LBS

## HOW MUCH DOES THE PUMP BOX ASSEMBLY WEIGH?

65LBS, BUT IT IS ALL HOUSED IN A COMPACT ROLL  
AROUND TOOLBOX

## WHAT ARE THE SAFETY FEATURES?

WITH OUR UNIT BEING POWER UP/ POWER  
DOWN WE ARE ABLE TO GO PAST 90  
DEGREES. WHEN THE LIFT IS ALL THE WAY UP  
IT IS LOCKED. ALL LIFTS HAVE A BATTERY  
DISCONNECT FEATURE AS WELL

## WHAT ARE THE STANDARD DIMENSIONS?

- 41 INCHES OVERALL WIDTH
- 46.75 INCHES LONG
- 3 INCHES TALL WHEN COLLAPSED
- 32 INCHES CENTER TO CENTER

**CONTACT**  
**Info@tricontoolinc.com**

**CELL: 770-787-1002**  
**OFFICE: 770-898-3907**  
**171 Maranatha Road, McDonough, GA. 30252**

### **WHO IS DIRTCARLIFT?**

DirtCarLift.com was established in 2013. The company was built on a need for a better, faster, and safer way to service the racecar at the track or around the shop.

We now have thousands of clients spanning multiple divisions across the U.S, Australia, The Netherlands & Canada.

We pride ourselves in manufacturing a top of line all CNC machined, Power up/Power down, 4500lb lifting capacity hydraulic pit lift that is backed by phenomenal customer service.